

SUNDAY
MARCH 3, 2019

MONDAY
MARCH 4, 2019

TUESDAY
MARCH 5, 2019

| | | | | | | |
|---|--|--|--|---|--|--|
| 7:30 a.m. - 1 p.m. | Satellite Registration Table - Hilton Albany / Lobby Area - Level A | | | | | |
| 9 - 10 a.m. | LEAF, Inc. Board Meeting - Hilton Albany / Empire AB - Level B | | | | | |
| 10 a.m. - 6:30 p.m. | Registration - Albany Capital Center - First Floor | | | | | |
| 10 - 11 a.m. | Federal Legislative Committee - Hilton Albany / State AB - Level B | | | | | |
| 10 a.m. - 5 p.m. | Profiles in Educational Leadership Video Production - Albany Capital Center / First Floor Lobby | | | | | |
| 10:30 - 11:30 a.m. | Cabinet Committee Breakfast Meeting - Hilton Albany / Capital AB - Level B | | | | | |
| 10:30 a.m. - 1:30 p.m. | New Superintendents' Institute Success Seminar - Hilton Albany / Chambers - Level A | | | | | |
| 11 a.m. - 12:30 p.m. | House of Delegates' Meeting and Brunch - Hilton Albany / Kelsey's - Level A | | | | | |
| 11 a.m. - 1:30 p.m. | Early Superintendent Career Institute - Hilton Albany / Anteroom - Level A | | | | | |
| 11:30 a.m. - 1:30 p.m. | Cabinet Member Institute - Hilton Albany / Capital AB - Level B | | | | | |
| 12:45 - 1:45 p.m. | Committee Lunch Meetings - Hilton Albany / Refer to App for Details | | | | | |
| 1:45 - 2 p.m. | Travel to Albany Capital Center | | | | | |
| 2 - 3:30 p.m. CTLE = 1Hr | Keynote Kickoff / Albany Capital Center - Second Floor / Education vs. Technology: Lessons Learned / Adam Bellow, Educator, Speaker, Author, & Entrepreneur / Albany Capital Center | | | | | |
| 3:30 - 4 p.m. | Beverage Break - Albany Capital Center / Marketplace of Ideas - Second Floor | | | | | |
| 4 - 5 p.m. Education Sessions CTLE = 1 Hour | Capital Room Albany Capital Center Strand 1 Mental Health Literacy: Trends Impacting the Social & Emotional Wellness of Today's Students | Meeting Room 1A Albany Capital Center Strand 6 Fiscal & Political Outlook for Our Public Schools | Meeting Room 1B Albany Capital Center Strand 3 Multi-Dimensional Wellness & Mental Health: Cultivating Effectiveness, Efficiency, and Inspiration | Meeting Room 2A Albany Capital Center Strand 5 Leadership, Trust, Threat-Rigidity: Work You Must Do Before THE WORK | Meeting Room 2B Albany Capital Center Multiple Strands Roundtable Discussions with Thought Exchange for Cabinet Level Members | Meeting Room 2C Albany Capital Center Strand 4 Level Up Learning with Breakout EDU with Keynote Adam Bellow |
| 5:00 - 6:30 p.m. | Opening Reception - Albany Capital Center / Marketplace of Ideas - Second Floor | | | | | |
| 6:30 p.m. | Dinner on Your Own / Strategic Partner Dinners | | | | | |
| 7 a.m. - 6:30 p.m. | Registration - Albany Capital Center - First Floor | | | | | |
| 7:30 - 8:45 a.m. | Committee Breakfast Meetings - Hilton Albany / Refer to App for Details | | | | | |
| 7:30 - 9 a.m. | Buffet Breakfast - Albany Capital Center / Marketplace of Ideas - Second Floor | | | | | |
| 8 - 8:45 a.m. | Sunrise Café Discussions - Albany Capital Center / Marketplace of Ideas - Second Floor / Six sessions available | | | | | |
| 8:45 - 9 a.m. | Travel to Albany Capital Center | | | | | |
| 9 - 10:30 a.m. | Monday Morning Keynote / Albany Capital Center - Second Floor / Problem Solving Generation / Jaime Casap, Chief Education Evangelist, Google | | | | | |
| 10:30 - 11 a.m. | Beverage Break - Marketplace of Ideas / Albany Capital Center - Second Floor | | | | | |
| 10:30 - 11 a.m. | Book Signing with Dr. Luvelle Brown, Ithaca - Albany Capital Center - Second Floor / Exhibit Booth #7 | | | | | |
| 10:30 a.m. - 3:30 p.m. | Profiles in Educational Leadership Video Production - Albany Capital Center / First Floor Lobby | | | | | |
| 11 a.m. - 12 p.m. Education Sessions CTLE = 1hour | Capital Room Albany Capital Center Strand 1 Part I - ACEs: Introduction to Adverse Childhood Experiences & Biology Associated with It | Meeting Room 1A Albany Capital Center Strand 1 Using Small Learning Communities to Enhance Middle Schools | Meeting Room 1B Albany Capital Center Strand 6 Legal Briefing: Tax Cap Conundrums | Meeting Room 2A Albany Capital Center Strand 2 Preparing All Students for College / Career: A Plan for ELL/MLL Success | Meeting Room 2B Albany Capital Center Strand 5 A Threat, Vulnerability, & Risk Assessment Saves Lives | Meeting Room 2C Albany Capital Center Multiple Strands NYSED Hot Topic Roundtables |
| 12 - 1 p.m. | Networking Lunch - Albany Capital Center / Marketplace of Ideas - Second Floor | | | | | |
| 1 - 2 p.m. Education Sessions CTLE = 1hour | Capital Room Albany Capital Center Strand 1 Part II - ACEs: Implementation of Systems' Responses for Children | Meeting Room 1A Albany Capital Center Strand 5 Meeting Expectations: Communicating with Parents in 2019 | Meeting Room 1B Albany Capital Center Strand 1 Feeding Hungry Minds: Leveraging School Breakfast to Support Student Engagement | Meeting Room 2A Albany Capital Center Strand 2 Prepare for 2019-20: Launching AP's New Annual Process | Meeting Room 2B Albany Capital Center Strand 4 Navigating the Cybersecurity Threat Landscape | Meeting Room 2C Albany Capital Center Strand 1 Scalable & Innovative Therapeutic Programming for the Next Generation |
| 2 - 2:30 p.m. | Beverage Break - Albany Capital Center / Marketplace of Ideas - Second Floor | | | | | |
| 2 - 2:30 p.m. | Singing Superintendents & Strategic Partner Rehearsal - Albany Capital Center / Multipurpose Room - Second Floor (Behind Stage Area) | | | | | |
| 2:30-3:30 p.m. Education Sessions CTLE = 1hour | Capital Room Albany Capital Center Strand 6 Advocacy Session | Meeting Room 1A Albany Capital Center Strand 1 Part I: Effective Social-Emotional, Behavioral, & Mental Health Supports in Schools | Meeting Room 1B Albany Capital Center Strands 4/5 A Culture of Love: Cultivating a Positive & Transformative Organizational Culture | Meeting Room 2A Albany Capital Center Strand 5 Developing the Community-based School | Meeting Room 2B Albany Capital Center Strand 5 Cyber Date Matters: Best Practices & Preparedness Tips | Meeting Room 2C Albany Capital Center Strand 6 Regional Advocacy with WSWHE BOCES |
| 2 - 4 p.m. | Career Connections: TRS Q&A - Capital Room Pre-Function Space - First Floor | | | Career Connections: Search Consultant Meetings - Capital Room Pre-Function Space - First Floor | | |
| 3:30 - 4 p.m. | Dessert Reception - Albany Capital Center / Marketplace of Ideas - Second Floor | | | | | |
| 4 - 5 p.m. Education Sessions CTLE = 1hour | Capital Room Albany Capital Center Strand 3 Empowering Effective & Efficient Stakeholder Engagement | Meeting Room 1A Albany Capital Center Strand 1 Part II: Effective Social-Emotional, Behavioral, & Mental Health Supports in Schools | Meeting Room 1B Albany Capital Center Strand 5 A Window to Your Community Soul | Meeting Room 2A Albany Capital Center Strand 5 Managing Complexity: The Superintendent as Juggler | Meeting Room 2B Albany Capital Center Strand 5 A Superintendent's Guide to School Construction | Meeting Room 2C Albany Capital Center Strand 5 Substitute Teachers? We've Got Them! Teacher Immersion Fellows Program |
| 4 - 6 p.m. | Future Superintendents' Academy Class - Hilton Albany / Chambers - Level A | | | | | |
| 5 - 6:30 p.m. | Specialty Tasting Member Event - Albany Capital Center / Pre-function Space - First Floor | | | | | |
| 6 - 8 p.m. | Future Superintendents' Academy Program Dinner - Hilton Albany / Chambers - Level A | | | | | |
| 7 - 8:30 a.m. | Networking Buffet Breakfast - Albany Capital Center / Second Floor | | | | | |
| 7:30 - 8:30 a.m. | Curriculum & Instruction Special Ed Sub-Committee Meeting - Albany Capital Center / Meeting Room 2C | | | | | |
| 7:30 - 8:30 a.m. | New Superintendent Breakfast with Commissioner Elia - Albany Capital Center / Capital Room / Open to New Superintendents Only | | | | | |
| 8 a.m. - 3 p.m. | Future Superintendents' Program - Hilton Albany / Anteroom - Level A | | | | | |
| 8:30 - 9:30 a.m. CTLE 1hr | Closing Ideas Keynote - Albany Capital Center / Commissioner of Education - MaryEllen Elia / Singing Superintendents & Strategic Partner Performance | | | | | |
| 9:30 a.m. | Walk to the Capitol for Lobby Day | | | | | |

ALBANY CAPITAL CENTER FLOORPLAN

Albany Capital Center – 55 Eagle Street, Albany, NY

First Floor

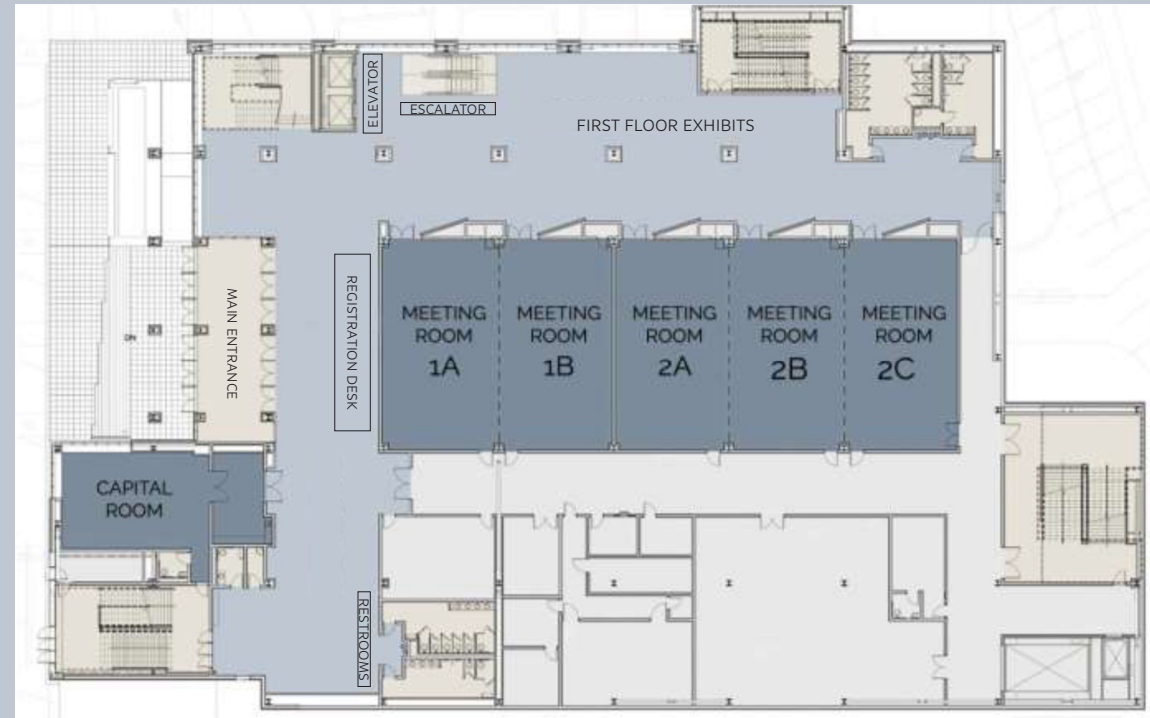

Second Floor

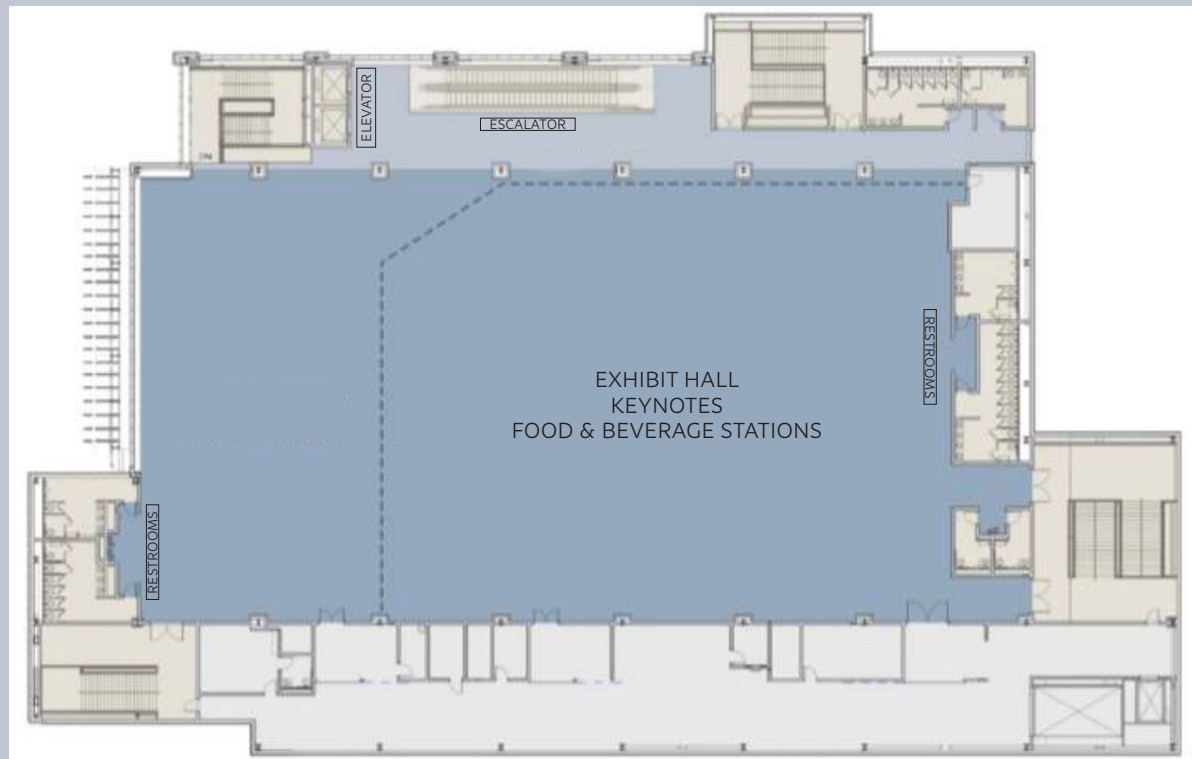

WELCOME!

SOCIAL MEDIA

The hashtag for the Institute:

 @NYSchoolSupts #NYSuptsWI

We encourage every educator to leverage their social media accounts to foster action!

Twitter: @NYSchoolSupts

Or follow our staff:

@csdedrick #LeadersMatter

@JazzConboy #WomenEdLeaders

@VreneliBanks #NYSupts4Diversity

@robertnlowry

@Greg_Berck

Instagram: nyschoolsupts

Like us on Facebook

<https://www.facebook.com/>

ALBANY CAPITAL CENTER (MAIN REGISTRATION)

The Council's Registration Desk is located on the first floor of the Albany Capital Center, just inside the main entrance on Eagle Street.

The Registration Desk will be open:
Sunday..... 10 a.m. – 6:30 p.m.
Monday 7 a.m. – 6:30 p.m.
Tuesday..... 7 a.m. – 9:30 a.m.

HOW TO ACCESS OUR WINTER INSTITUTE APP

Use the App/Play Store on your iOS or Android device and search for: NYSCOSS and look for The Council's Mobile Experience (etouches). Select this app and follow the install directions from store. This will download to your phone. You can find the entire Winter Institute program online.

ALBANY CAPITAL CENTER WIFI

Albany Capital Center WiFi
Access Network: ACC_GUEST
Password: No Password Needed

HILTON ALBANY WIFI

- Connect to HHonors network;
- Open browser;
- Select promotion code;
- Select agree to terms;
- Click next; Enter Password: NYSCOSS19
Click Connect

SHUTTLE SERVICE & SCHEDULE

For the convenience of Institute attendees, a complimentary shuttle service will operate Sunday through Tuesday morning. Just call **518.646.1443 or 518.364.3669** for Tech Valley Shuttle for travel between the Albany Capital Center and participating hotels in our room block. You can also call their office directly at 518.203.8748. Please indicate that you are attending The Council's/LEAF, Inc. Winter Institute!

Sunday, March 3, 2019 / 10 a.m. – 11 p.m.

Additional Shuttles available from 1 – 2:30 p.m. between Hilton Albany and Albany Capital Center prior to opening keynote on Sunday. Keynote begins at 2 p.m.

Monday, March 4, 2019 / 7 a.m. – 11 p.m.

Additional Shuttles available from 8 – 9:30 a.m. between Hilton Albany and Albany Capital Center prior to second keynote on Monday. Keynote begins at 9 a.m.

Tuesday, March 5, 2019 7 a.m. – 11 a.m.

COMMUTER PARKING

Commuter parking is available beneath the Albany Capital Center. Please note that the garage closes at 11 p.m. No overnight parking is allowed, as the gates will be locked.

